

## DEFENDER HP

HIGH PROFILE WRAPPING MACHINE

---



Designed for safety.

Built tough for trouble free operation.

Innovative stretch-packaging solutions

 **Defender**

## Features

- EZ-Load carriage for quick and safe roll changes
- Enclosed tower to eliminate pinch points
- User friendly controls
- Solid state controls
- Forklift portable from front and back
- 3 year machine warranty
- Compact footprint
- Load-cell controlled corner compensation

# DEFENDER HP

## HIGH PROFILE WRAPPING MACHINE

### Standard Features

- Designed with safety in mind
  - No pinch-point on tower
  - Operator controls away from all moving components.
- Cycle pause (for top sheet or label application)
- Separate top and bottom wrap counters
- Variable carriage lift and turntable speeds
- Load reinforcing (Banding) control
- Adjustable film tension
- 1/2 HP drive motors
- Soft-start and stop turntable drive
- Adjustable over-wrap on load
- Pre-stretch from 50 to 300% (200% Standard)

### Available Options

- Tower extension for taller loads
- Base extension for wider loads
- 6,000 lb capacity turntable
- 72" x 72" turntable
- Automatic film cutter
- Cold temperature package
- Dual turntable
- Scale package
- Top platen for unstable loads
- Film roping bar

### Specifications

Production Rate:	up to 40 loads per hour
Maximum Load Size:	52"W x 52"W x 80"H
Maximum Load Weight:	4000 pounds
Voltage:	115 VAC, 15 amp
Warranty:	3 year parts
Shipping Weight:	1000 lbs

*Features and specifications subject to change without notice*

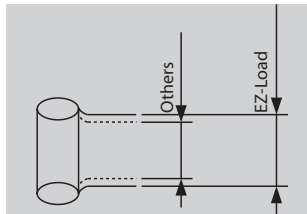

High-efficiency EZ-Load pre-stretch carriage minimizes neck-down and improves film yield.



Enclosed tower eliminates pinch points and prevents injury.

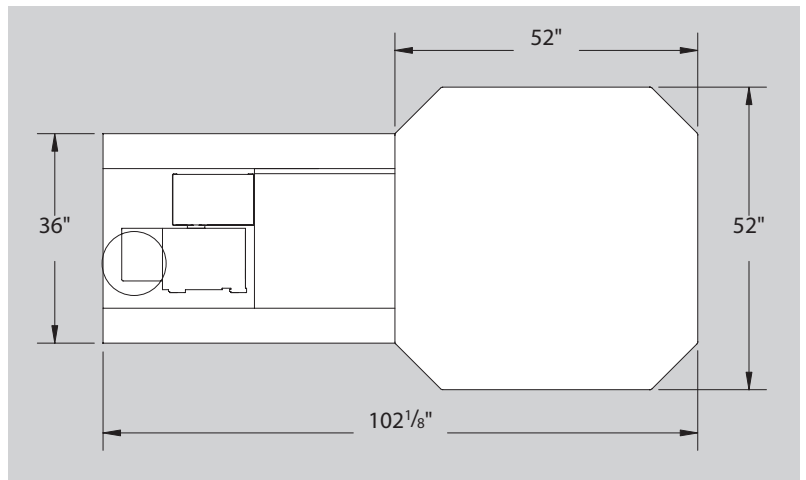

Represented By:

DEFENDER HP-02/16-116234