

# STANDARD FAN PANELS

10" to 84 1/2" Sizes

Fan panels are produced in most materials and gauges using existing, stock tooling to save you money for prototypes through production quantities. Options include flat sheet, corner notched, press broken edges, with holes, welded corners, straight or flared throat.

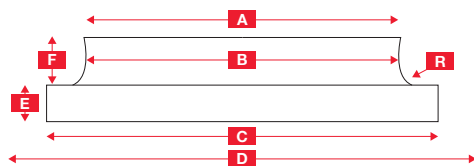

- A** Flare Diameter (OD)
- B** Throat Diameter (OD)
- C** Press Broken Square (OD)
- D** Maximum Flat Square
- E** Flange Length (OD)
- F** Throat Depth
- R** Throat Radius

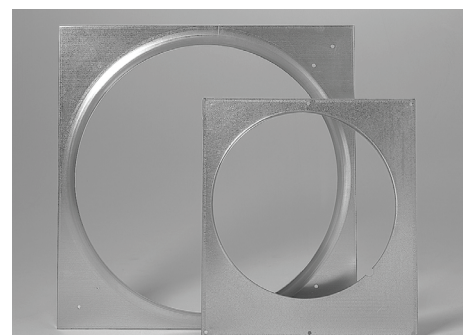

Standard Fan Size	Suggested Metal Gauge	A**	B*	C*	D*	E***	F*	R
		All Dimensions in Inches						
10	18	10 3/4	10 1/2	14 x 14	16	1	1 1/2	5/8
12	18	12 3/4	12 1/2	16 x 16	18	1	1 1/2	5/8
14	18	14 3/4	14 1/2	18 x 18	20	1	1 3/4	5/8
15	18	15 1/4	14 7/8	18 x 18	20	1	1 3/4	5/8
16	16	17 1/4	16 7/8	20 x 20	22	1	2 1/2	5/8
18	16	19	18 3/4	22 x 22	24	1	2 1/2	5/8
20	16	21 1/4	20 7/8	24 x 24	26	1	2 3/4	5/8
24	16	25 1/4	24 7/8	30 x 30	35 1/2	2 3/4	3 5/8	1 1/2
26	16	27 1/4	26 7/8	32 x 32	37 1/2	2 3/4	3	1 1/2
28	16	29 1/4	28 7/8	34 x 34	39 1/2	2 3/4	3 3/4	1 1/2
30	16	31 1/4	30 7/8	36 x 36	41 1/2	2 3/4	3 3/4	1 1/2
32	16	33 1/4	32 7/8	38 x 38	43 1/2	2 3/4	3 3/4	1 1/2
34	16	35 1/2	34 3/4	40 x 40	45 1/2	2 3/4	4	1 1/2
36	14	37 3/4	36 7/8	42 x 42	47 1/2	2 3/4	4 1/4	1 1/2
42	14	44	42 7/8	48 x 48	53 1/2	2 3/4	4 3/4	1 1/2
48	14	50	48 7/8	54 x 54	59 1/2	2 3/4	4 3/4	1 1/2
52	14	54	53 1/4	56 x 56	59 1/2	1 1/2	4 1/2	1 1/2
54	14	56 1/4	55	60 x 60	65 1/2	2 3/4	5	1 1/2
60	12	62 1/4	61	66 x 66	71 1/2	2 3/4	5 1/2	1 1/2
66	11		66 7/8	72 x 72	77 1/2	2 3/4	6	2
72 1/2	11		73		95 1/2		6 1/4	4
84 1/2	11		84 1/2		95 1/2		6 1/4	4

\* Standard specifications listed. C and D can be made to any specified size.  
 \*\* Dimensions not applicable when panels are supplied with straight throat (without flares) for attachment to ducts.  
 \*\*\* Non-standard flange lengths also available.

© June 2018