

SA SERIES SEALER

FOR REGULAR AND HIGH-TENSILE STEEL STRAPPING



Features

- Hardened tool steel parts for long wear
- Double notch down-cut seal for high joint efficiency
- Compatible with feed wheel type tensioners
- Easy replacement of wearing parts
- Ideal for regular shaped packages
- Available for 1/2", 5/8" and 3/4" strapping
- Samuel quality built in to every unit

SA Series Sealers

FOR REGULAR AND HIGH-TENSILE STEEL STRAPPING

Description

The Samuel SA Series sealer has been designed for a broad range of common strapping applications. This sturdy sealer is built with hardened tool steel, to provide you with a lifetime of reliable use under demanding conditions. The sealer is available in three models which can handle standard and high tensile strapping in 1/2", 5/8" and 3/4" wide and in gauges from .015" to .023". Used in combination with a standard feedwheel type tensioner, the SA Series sealer is designed to crimp an open flange seal in a double down notch configuration.



SA Series Sealers

Model	Size
SA12-0	1/2" (13 mm)
SA58-0	5/8" (16 mm)
SA34-0	3/4" (19 mm)

Parts

Item	Qty	Model	Part #	Description
1	2	SA12-0	D-21730-F	Side plate (for 1/2" model only)
		SA58-0	D-21731-F	Side plate (for 5/8" model only)
		SA34-0	D-21732-F	Side plate (for 3/4" model only)
2	3	SA12-0, SA58-0, SA34-0	D-20255-F	Pin, Jaw
3	2	SA12-0, SA58-0, SA34-0	B-5287-A	Handle Assembly
4	8	SA12-0	D-78884-F	Jaw (for 1/2" model only)
		SA58-0, SA34-0	D-20252-F	Jaw (for 5/8" & 3/4" models only)
5	2	SA12-0	D-78885-F	Anvil (for 1/2" model only)
		SA58-0	D-20253-F	Anvil (for 5/8" model only)
		SA34-0	D-81112-F	Anvil (for 3/4" model only)
6	2	SA12-0, SA58-0, SA34-0	D-15706-F	Pin, Link
7	1	SA12-0, SA58-0, SA34-0	D-24587-F	Bolt .250-20 x 1.375
8	1	SA12-0, SA58-0, SA34-0	D-16651-F	Nut .250-20, Elastic Stop

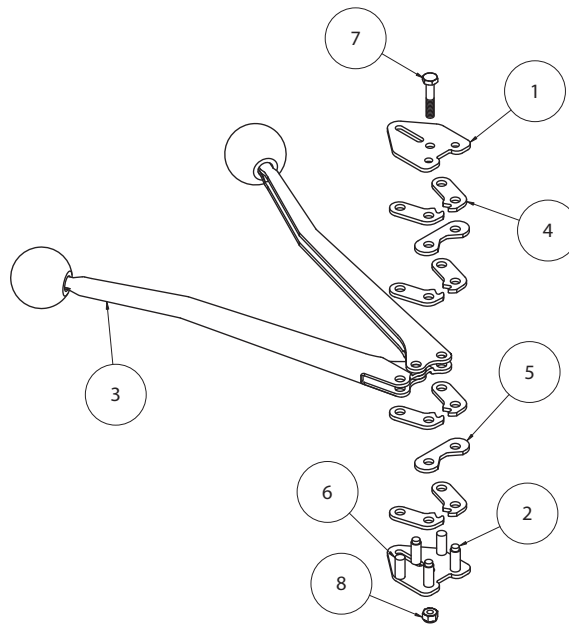

Represented By:

SAS-05/12-100448